

宗 地 图

XDG (XQ) -2020-9号地块

单位: m · m²

3493.75-40539.00,
3494.00-40539.00,
3494.00-40539.25

320292005128GB00033

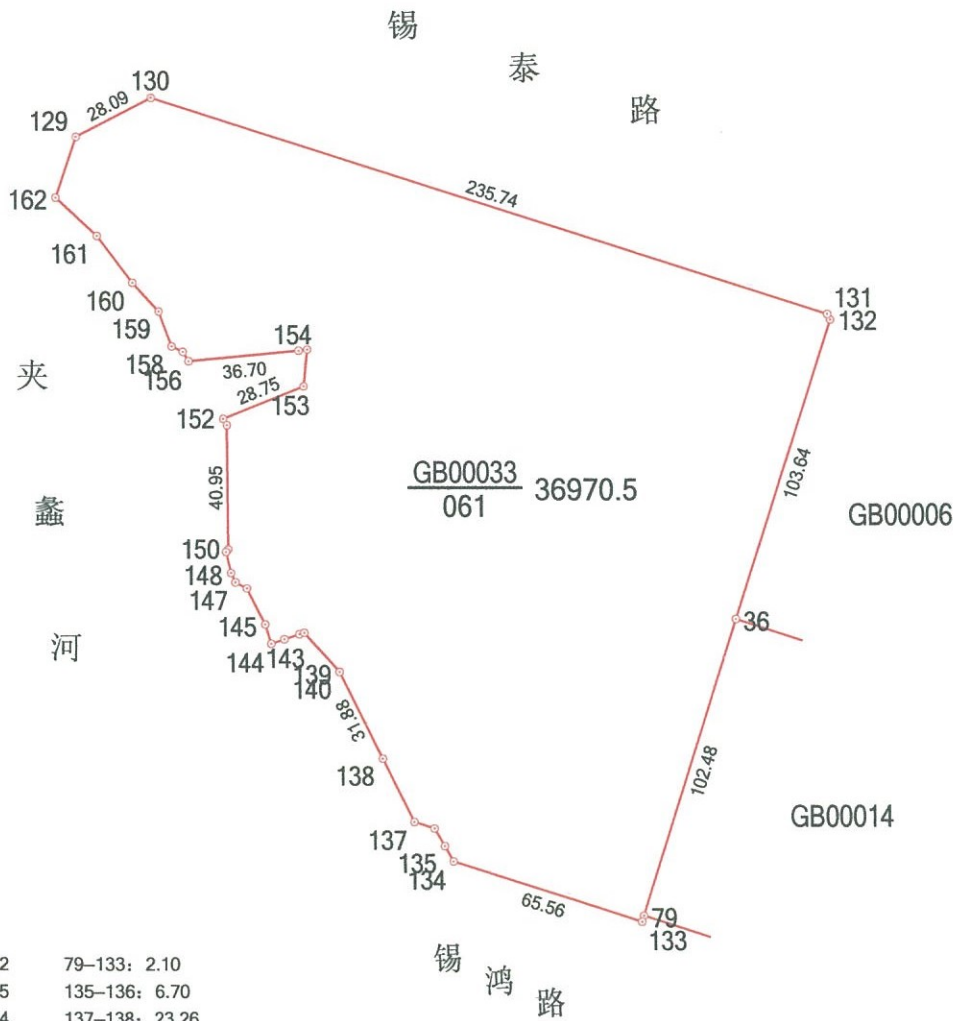

131-132: 2.12	79-133: 2.10
134-135: 5.85	135-136: 6.70
136-137: 7.04	137-138: 23.26
139-140: 0.12	140-141: 17.38
141-142: 1.66	142-143: 5.27
143-144: 4.58	144-145: 6.67
145-146: 13.29	146-147: 4.30
147-148: 3.42	148-149: 7.13
149-150: 1.13	151-152: 2.45
153-154: 12.21	154-155: 2.91
156-157: 3.62	157-158: 4.09
158-159: 12.34	159-160: 12.82
160-161: 19.41	161-162: 18.61
162-129: 21.19	



绘图员: 吴景宇

1:2500
审核员: 常鹏

2020年7月8日

界址点成果表

宗地号 320292005128GB00033

权利人 XDG(XQ)-2020-9号地块

宗地面积（平方米） 36970.5

界址点坐标

顺序号	点号	坐标		边长 (m)	备注
		X (m)	Y (m)		
1	129	3494137.480	40539011.381	28.09	
2	130	3494150.436	40539036.308	235.74	
3	131	3494079.192	40539261.024	2.12	
4	132	3494077.312	40539262.007	103.64	
5	36	3493978.633	40539230.338	102.48	
6	79	3493880.916	40539199.458	2.10	
7	133	3493878.913	40539198.822	65.56	
8	134	3493898.722	40539136.321	5.85	
9	135	3493903.799	40539133.412	6.70	
10	136	3493909.588	40539130.030	7.04	
11	137	3493911.726	40539123.323	23.26	
12	138	3493932.539	40539112.933	31.88	
13	139	3493961.064	40539098.693	0.12	
14	140	3493961.178	40539098.660	17.38	
15	141	3493974.014	40539086.943	1.66	
16	142	3493973.577	40539085.340	5.27	
17	143	3493971.883	40539080.354	4.58	
18	144	3493970.408	40539076.016	6.67	
19	145	3493976.771	40539074.018	13.29	
20	146	3493988.617	40539068.001	4.30	
21	147	3493990.622	40539064.196	3.42	

界址点成果表

宗地号 320292005128GB00033

权利人 XDG(XQ)-2020-9号地块

宗地面积（平方米） 36970.5

界址点坐标

顺序号	点号	坐标		边长 (m)	备注
		X (m)	Y (m)		
21	147	3493990.622	40539064.196	3.42	
22	148	3493993.720	40539062.743	7.13	
23	149	3494000.659	40539061.116	1.13	
24	150	3494001.506	40539061.860	40.95	
25	151	3494042.450	40539061.473	2.45	
26	152	3494044.543	40539060.205	28.75	
27	153	3494055.252	40539086.885	12.21	
28	154	3494067.394	40539088.135	2.91	
29	155	3494067.000	40539085.255	36.70	
30	156	3494063.497	40539048.722	3.62	
31	157	3494066.597	40539046.843	4.09	
32	158	3494068.393	40539043.164	12.34	
33	159	3494079.938	40539038.821	12.82	
34	160	3494089.357	40539030.122	19.41	
35	161	3494104.800	40539018.366	18.61	
36	162	3494117.382	40539004.655	21.19	
37	129	3494137.480	40539011.381		